

LEVEL INDICATOR MAGTOP

- Totally safe
- Easy reading
- Reliable indication
- Shock resistant
- Construction: Stainless steel, PVC, PPH, PVDF
- Level switches
- 4-20 mA transmitter

PRINCIPLE

Direct reading of fluid level in tanks, even with an opaque measuring tube. The mechanical and chemical features of measuring tube and parts allow an installation on tank storage for dangerous products (hot water under pressure, bases or acids).

Optional level switches are mounted along the guiding tube, as well as an analogical transmitter (continuous level sensor) with a 4-20 mA or resistor output signal.

ACCESSORIES

The switches BSM, BRK, BRT may be mounted along the measuring tube, please see our documentations 585-01, 585-02.

A continuous level sensor RTM may also be mounted beside the measuring tube, please see the documentation 586-01. Transmitters are with a potentiometrical output (in Ohm) or with a 4-20 mA signal. Graduated rulers are specifically designed in PVC or stainless steel. Scales are in [%] or in [cm] or graduations in volume. They are mounted on the side of the measuring tube, close to the magnet ruler.

MODELS

In standard, those equipments are manufactured in stainless steel for by-pass mounting, process connections threaded or with flanges. For aggressive products the material could be PVC, PPH or PVDF. It is possible to realize the same principle instrument above the tank. In this case a free space on the top should be equal to the immersion length.

ORDERING

The following process parameters must be specified with the order.

Liquid:
Specific weight:
Pressure:
Temperature:

Above information will appear on the TAG plate.

A complete definition is done with the descriptions in the next pages. Before manufacturing, we send a drawing for conformity acceptance. Options have to be clearly specified.

PED 97/23/EC, or ATEX versions are available. (contact us)

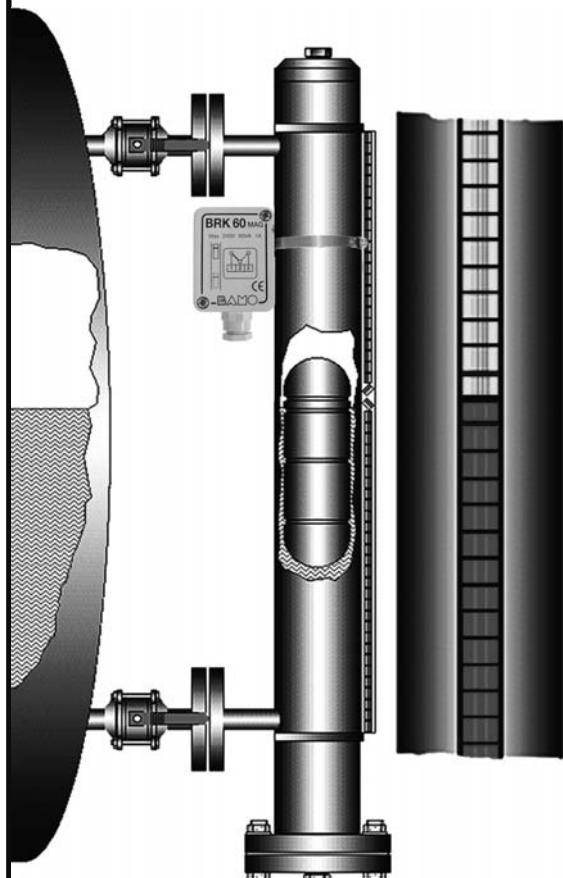

560

BAMO MESURES

22, Rue de la Voie des Bans - Z.I. de la Gare - 95100 ARGENTEUIL

Tél : (+33) 01 30 25 83 20 - Web : www.bamo.fr

Fax : (+33) 01 34 10 16 05 - E-mail : info@bamo.fr

**LEVEL INDICATOR
MAGTOP**

19-03-2014

560 11 01 J

NIV

560-01/1

DESCRIPTION AND TECHNICAL FEATURES

Material

Stainless steel

Process connections

DN 15 - PN 16

DN 20 - PN 16

DN 25 - PN 16

DN 32 - PN 16

BSP 1/2"

BSP 3/4"

BSP 1"

Other type

Distance between flanges axis

500 mm to 5 000 mm

Options

Graduated ruler: DOC 583-03

Level switches: DOC 585-01 / DOC 585-02

Continuous level transmitter: DOC 586-01

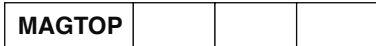

MAGTOP

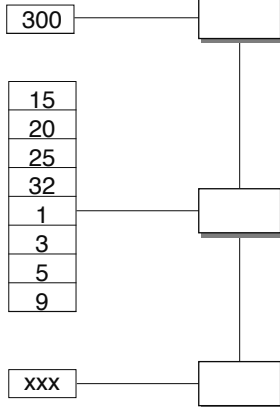

Magnet ruler

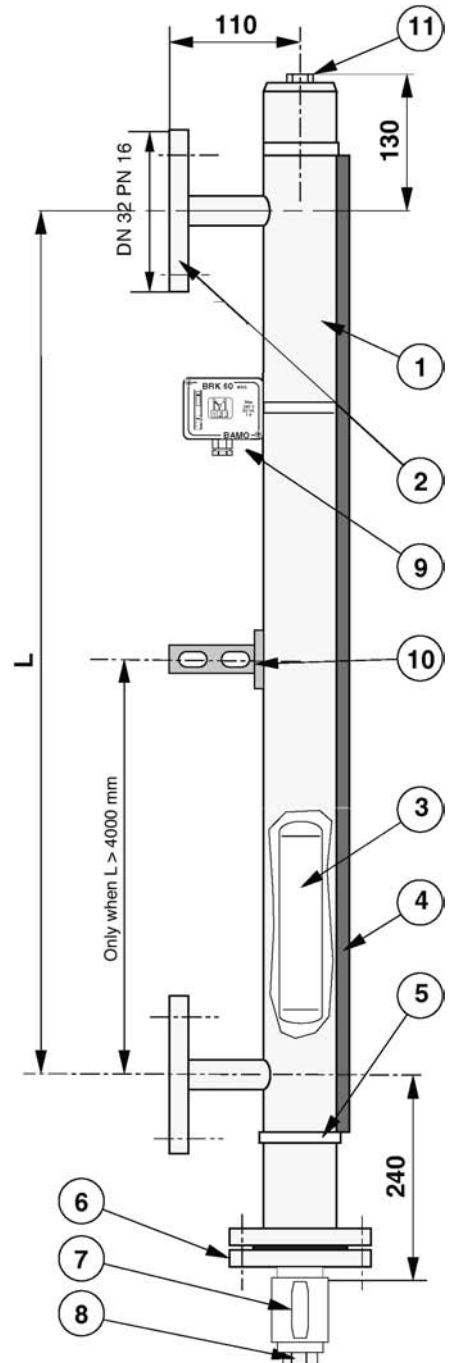
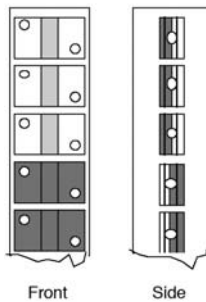

COMPLEMENTARY INFORMATION

When the length is over 4000 mm, the instrument is manufactured in two parts. Supplementary supports are welded on the guiding tube: they will be fixed on site on the tank. From the drawing, the end-user could confirm or modify the lieu of those supports. Before manufacture, a drawing is sent for acceptance.

NOMENCLATURE

- 1 Stainless steel 316 L guiding tube, diameter 60.3 mm
- 2 Flanges, ND 15 to ND 32, nominal pressure NP 10
- 3 Magnetic float
- 4 MAKROLON or Aluminum magnet ruler (according to temperature)
- 5 Magnet ruler fixing collar, stainless steel 304
- 6 Flange for maintenance
- 7 Draining valve (option)
- 8 BSP 1/2" draining plug
- 9 Level switches (option)
- 10 Supplementary support (when necessary)
- 11 BSP 1/2" Vent hole with tap (option)

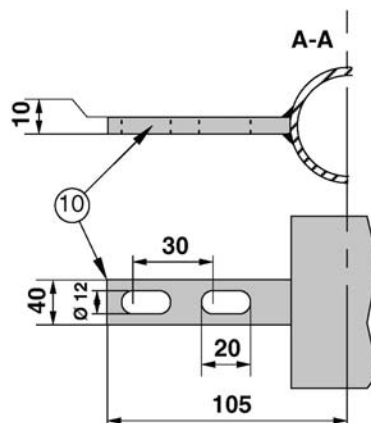

VENT HOLE (Optional)

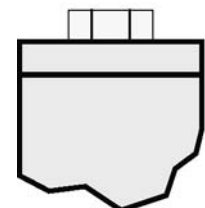

BAMO MESURES

22, Rue de la Voie des Bans - Z.I. de la Gare - 95100 ARGENTEUIL

Tel : (+33) 01 30 25 83 20 - Web : www.bamo.fr

Fax : (+33) 01 34 10 16 05 - E-mail : info@bamo.fr

LEVEL INDICATOR MAGTOP

19-03-2014

560 I1 01 J

NIV

560-01/2

DESCRIPTION AND TECHNICAL FEATURES

Material

PVC
PPH
PVDF

801
803
806

Process connections

ND 25 - PN 10(*)
ND 32 - PN 10(*)
Other type

(*): 6 bar as a maximum working pressure of the level indicator

25
32
9

Distance between flanges axis

500 mm to 5 000 mm

xxx

Options:

Graduated ruler: DOC 583-03

Continuous level transmitter: DOC 586-01

Level switches: DOC 585-02 (*Only BRK-60 MAG be used on this indicator*)

MAGTOP

MAGTOP

Magnet ruler

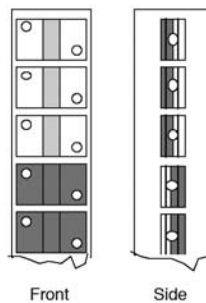

Front

Side

COMPLEMENTARY INFORMATION

Mainly used for aggressive fluid applications, these MAGTOP are made of plastic materials. Floats are manufactured in accordance with fluid specific weight and with the same material as the MAGTOP. Before manufacture, a drawing is sent for acceptance.

The maximum pressure should not be above 6 bar at 20°C.

OPTION

When the length is over 2000 mm, the instrument is manufactured in two parts. Supplementary supports fit the guiding tube: they will be fixed on site on the tank. From the drawing, the end-user could confirm or modify the lieu of those supports.

NOMENCLATURE

- 1 PVC, PPH or PVDF guiding tube
- 2 MAKROLON magnet ruler
- 3 PVC, PPH, PVDF magnetic float
- 4 Supplementary support (when necessary)
- 5 PVC or PPH steel reinforced flanges, ND 25 or ND 32
- 6 Sealing surface
- 7 Magnet ruler fixing collar, stainless steel 304
- 8 Union (3 pieces) for maintenance
- 9 Drain tap
- 10 Draining valve (option)
- 11 Level switches (option)

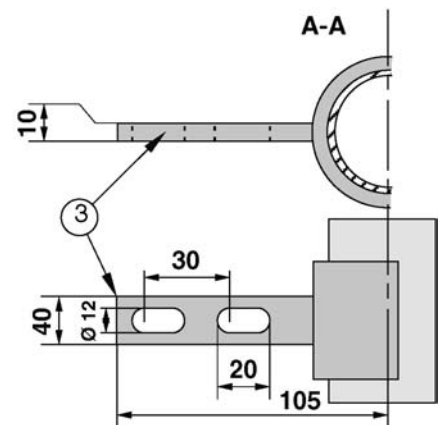
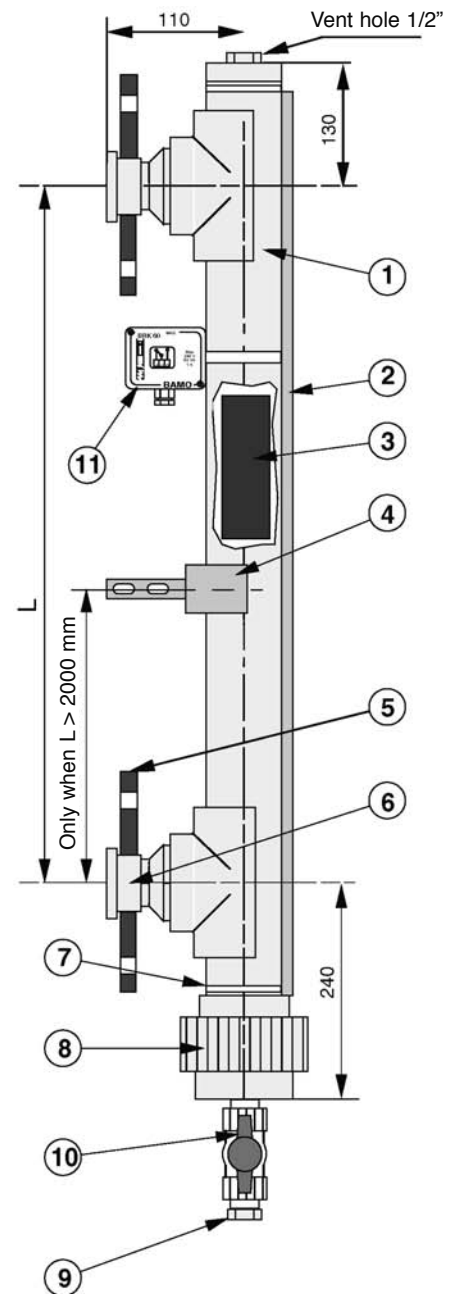

BAMO MESURES

22, Rue de la Voie des Bans - Z.I. de la Gare - 95100 ARGENTEUIL

Tel : (+33) 01 30 25 83 20 - Web : www.bamo.fr

Fax : (+33) 01 34 10 16 05 - E-mail : info@bamo.fr

**LEVEL INDICATOR
MAGTOP**

19-03-2014

560 I1 01 J

NIV

560-01/3

DESCRIPTION AND TECHNICAL FEATURES

Type

Tube, St steel 316 L, Ø 63 mm

Connecting

ND 80 PN 16
ND 100 PN 16
ND 125 PN 16
Other

Distance between flanges (L)

Max. 1 000 mm

Options

Graduated ruler: DOC 583-03
Level switches: DOC 585-01 / DOC 585-02
Continuous level transmitter: DOC 586-01

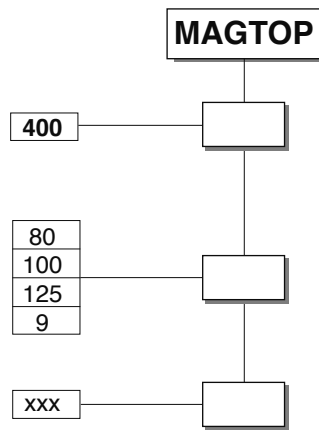

NOMENCLATURE

- 1 Magnet ruler fixing collar, stainless steel 304
- 2 MAKROLON or aluminum magnet ruler (according to T°)
- 3 Level switches (option)
- 4 Indication tube, stainless steel 316 L, Ø 63 mm
- 5 Magnet actuator
- 6 ND 65 to ND 125 PN 10/16 flange
- 7 Guiding tube
- 8 Push rod
- 9 Float
- 10 Float stopper
- 11 BSP ½" Vent hole with tap (option)

Magnet ruler

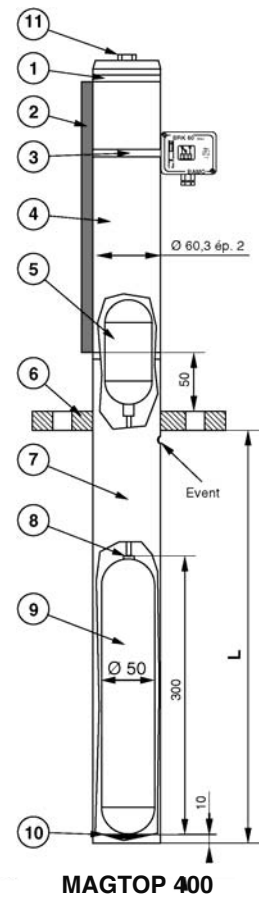
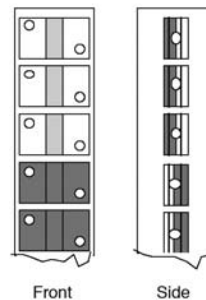

MAGTOP 400

Type

Indication tube, St steel 316L, Ø 63 mm
Guiding tube – Ø 104

Connecting

ND 125 PN 16
Other

Hauteur L

500 mm to 5000 mm

Options

Graduated ruler: DOC 583-03
Switches: DOC 585-01/ DOC 585-02
Continuous level transmitter: DOC 586

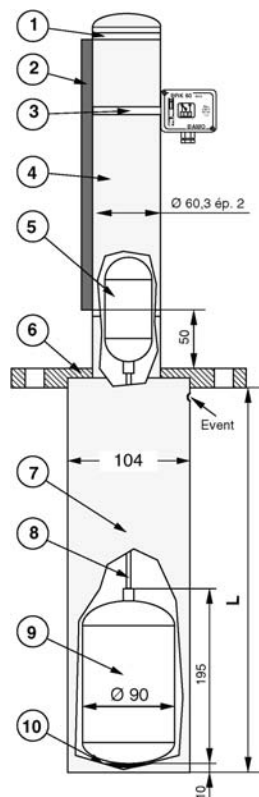
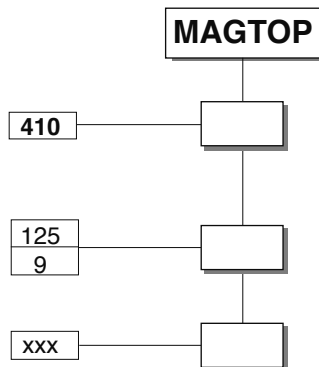

MAGTOP 410

COMPLEMENTARY INFORMATION

When the length is over 2500 mm, the instrument is manufactured in two parts. Before manufacture, a drawing is sent for acceptance.

BAMO MESURES

22, Rue de la Voie des Bans - Z.I. de la Gare - 95100 ARGENTEUIL
Tél : (+33) 01 30 25 83 20 - Web : www.bamo.fr
Fax : (+33) 01 34 10 16 05 - E-mail : info@bamo.fr

LEVEL INDICATOR MAGTOP

19-03-2014

560 I1 01 J

NIV

560-01/4