

# Level controller with stop valve VAFLO



- Self-sufficient system
- Level controller
- Adjustable height
- Float in Polyester or in PPH

## AUTOMATIC LEVEL CONTROLLER WITH FLOAT VALVE

Designed for chemical industry, this valve regulates a fluid level automatically, without external power supply. All components are made of materials, well-known for chemical compatibilities. The height adjustment is possible along 120 mm for adjustment when mounting the system.

## PRINCIPLE

The float rising with the fluid level, closes the inlet until the flow stops.

## TECHNICAL FEATURES

Adjustment along 120 mm  
Standard flow rate: 1800 l/h with 1 bar – Pressure limit: 6 bar  
On request Q=3600 l/h with 1 bar – Pressure limit: 4 bar

## FITTINGS

BSP 1/2" (male)  
Flange ND 15 mm / PN 10 bar (flat seal)

Fitting and valve are of the same material.

## CODE NUMBERS AND REFERENCES

Code	Reference	Float	Guiding rod	Body	Seal	Fitting
527 015	VAFLO 15	Polyester	AISI 316 L	Hostaform	NBR	1/2" MG
527 020	VAFLO 20	PPH	Hastelloy B2	PPH	FPM	1/2" MG
527 025	VAFLO 25	PPH	Hastelloy B2	PPH	FPM	Flange DN 15

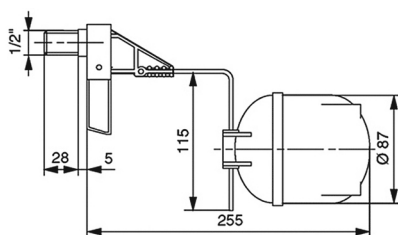

VAFLO 15

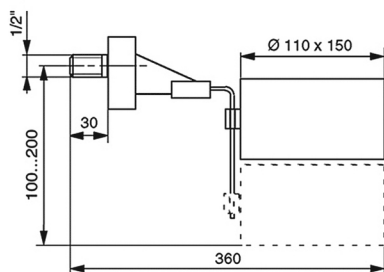

VAFLO 20

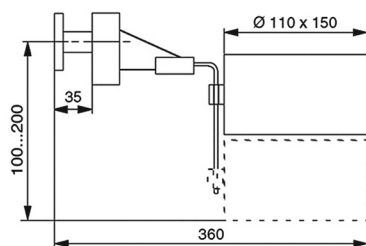

VAFLO 25

# BAMO MESURES

22, Rue de la Voie des Bans · Z.I. de la gare · 95100 ARGENTEUIL  
Tel +33 (0)1 30 25 83 20 Web www.bamo.fr  
Fax +33 (0)1 34 10 16 05 E-mail info@bamo.fr

Level controller with stop  
valve  
**VAFLO**

03-12-2018

D-527.01-EN-AB

NIV

527-01 /1