



INSTRUCTIONS MANUAL

Alarming unit, 1 sensor input MAXIMAT® TC1 or MAXIMAT® TC1-B

Safety Precautions

- Installation, initial start-up and maintenance may only be performed by trained personnel.
- Device must be connected and only to a power supply in conformity with features mentioned on the device.
- Device must be disconnected from all sources of power during installation and maintenance work.
- Device may only be operated under the conditions specified in the operating instructions.

Description

TC1 is designed for overflow detectors and leakage detectors MAXIMAT® and MAXITOP.

Alarm system TC1 has a self-diagnostic test; it surveys the sensor, the loop and completes all the alarm procedure.

Acoustic alarm complies with directives (ZG-ÜS) for overflow detectors.

The detector is directly powered through the TC1. Alarm status is provided by detector to TC1 with signals it with audible and visual alarms. The alarm reset is done by operator on the front board.

The TC1B version allows to connect any sensor, which have a potential free contact output.

Status is visualised by LED:

- Green LED: → Normal monitoring status
 Yellow LED: → Alarm occurred, not yet reset
 Red LED: → Alarming status

The audible alarm (buzzer) may be disabled by moving internal strap.

Technical features

Supply power:	230 V AC ±10% - 50/60 Hz
Power consumption:	approx. 2 VA / 2 W max.
Protection:	IP 65 (acc. EN 60 529)
Ambient temperature:	-20...+60°C
Housing:	Polycarbonate Wall mounting
Input:	1 detector, MAXIMAT or MAXITOP serie (MAXIMAT TC1) or 1 sensor with potential free contact (MAXIMAT TC1-B)
Electric connections:	Screw connectors
Output:	1 changeover contact
Switching power:	230 V AC / 3 A
Indications:	Green LED → in operation Yellow LED → alarm not yet reset Red LED → alarm in curse
Audible alarm:	> 75 dB
Control elements:	Reset push button for test and alarm acknowledgement
CE Mark:	In accordance with low voltage directive (2006/95/EC) and EMC directives (2004/108/EC)

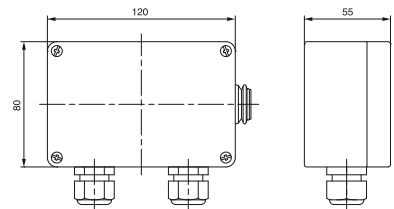

Start-up

When connecting an instrument with an alarm delay over 1 minute (Example: MAXIMAT CX), TC1 creates an alarm as soon as it is powered, and as well as after a power shut down.

Tests

TC1 has a self-diagnostic test: While the push button is pressed, yellow LED and buzzer are active.

Maintenance

TC1 does not need special maintenance.
Consider the detector to establish a correct maintenance of the system.

Indications, control and wiring

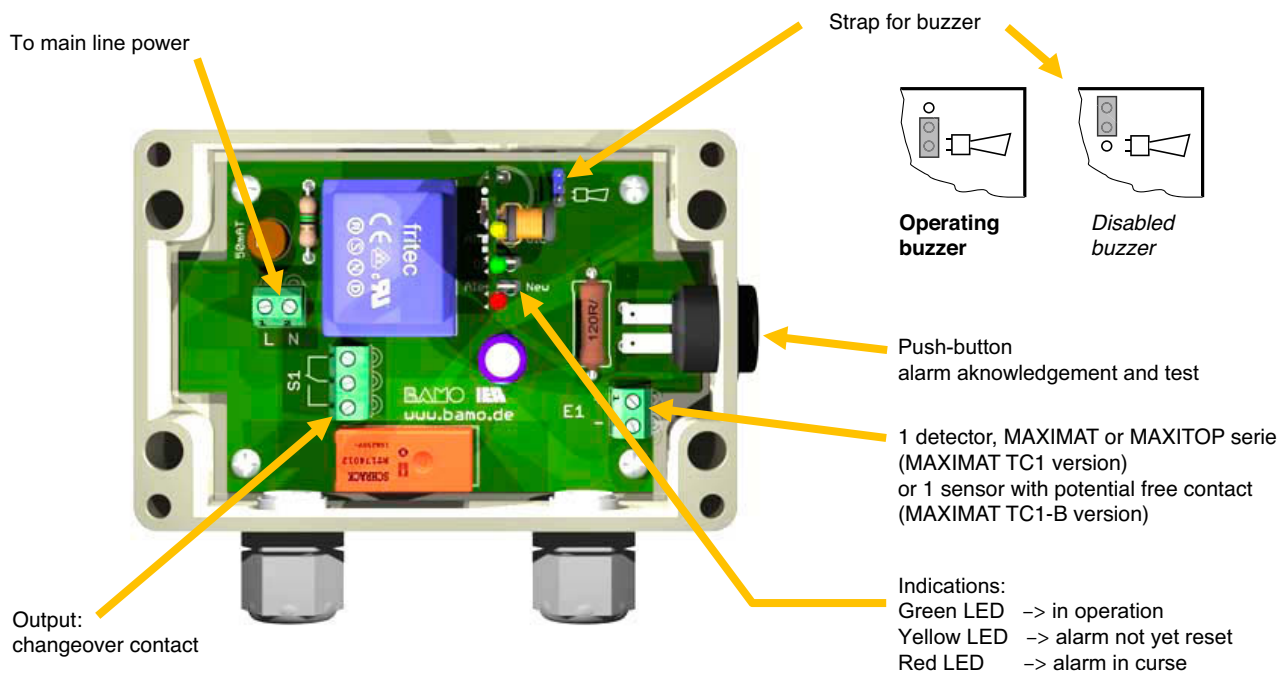

Electrical connections

