

JET PUMP SP 820



- From DN10 to DN80
- To pump, mixt and vacuum
- Vacuum untill 3 meters
- Driving fluid: water
- Vacuumed fluid: liquides or gas
- Contruction: PVC - PPH - PVDF

PRINCIPLE

Driving liquid, which comes in main flow direction out of the nozzle installed in the water-jet pump, is accelerated by the diameter reduction of the nozzle. This acceleration causes low pressure at the suction spigot end sucking liquids or gaseous media.

The suction volume is a function of the driving liquid pressure and the nozzle bore.

Jet pump is used for:

- pumping
- mixing
- vacuum production

Driving fluid flow is depending on nozzle hole diameter.

Vacuumed fluid flow is depending on:

- driving fluid flow
- jet pump outlet pressure (counter pressure)
- Vacuumed liquide deansity
- heigh of liquide charge or vacuum

Vacuum production is depending on driving fluid pressure/flow

USING

Jet pump choice must be done from diagram including different uppers data. Jet pump is delivered undrilled nozzle. setting must be done successive drilling untill good diameter.

A set of diagram pressure/hole/flow, for water/water or air /water, is at your disposal.

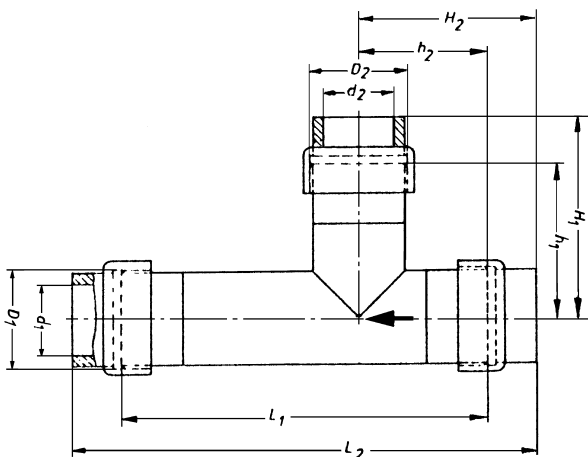

CODES & DIMENSIONS

Type	DN	Ø	PVC	PPH	PVDF	d1	D1	L1	h1	H1	d2	D2	L2	h2	H2
P20 10	10	16	P54 385	P61 385	P60 997	16	¾	110	35	54	16	¾	147	40	59
P20 15	15	20	P54 386	P59 679	P59 800	20	1	125	35	55	16	¾	170	38	60
P20 20	20	25	P54 389	P57 140	P67 425	25	1 ¼	145	40	59	16	¾	195	45	70
P20 25	25	32	P54 387	P60 123	P59 464	32	1 ½	195	71	96	32	1 ½	245	71	96
P20 32	32	40	P54 388	P59 794	P54 380	40	2	239	87	116	40	2	297	87	116
P20 40	40	50	P54 390	P59 698	P65 591	50	2 ¼	301	105	139	50	2 ¼	369	105	139
P20 50	50	63	P54 391	P61 335	P67 883	63	2 ¾	351	128	169	63	2 ¾	433	128	169
P20 63	65	75	P64 866*	P65 948*	P67 884*	75	3 ½	388	128	175	75	3 ½	483	128	175
P20 80	80	90	P61 352*	P65 949*	P65 592*	90	4	466	150	206	90	4	578	150	206

All devices are delivered with unions end connections,
excepted *: smooth connections

BAMO MESURES

13, rue Pasteur - 95100 ARGENTEUIL - FRANCE
Tél : (+33) 01 30 25 83 20 - E-mail : info@bamo.fr
Fax : (+33) 01 34 10 16 05 - Site : http://www.bamo.fr

JET PUMP
SP 820

PLAS

957/11

957

23-02-2004

957 11 01 B