

Flow rate controller and indicator DUG



- Works in all positions
- Reading on a graduated glass tube
- Pressure without effect
- Construction: brass or stainless steel
- Adjustable contact NO (change over contact on request)
- Scale: 11 ranges from 0.2 up to 250 L/min /Water /20°C
- Pressure up to 10 bar /20°C
- Temperature up to 100°C (160°C on request)

PRINCIPLE

The flow rate controller DUG operates with the float measuring principle. It is recommended for fluids with a viscosity close to water viscosity.

TECHNICAL FEATURES

Pressure drop:	0.02 to 0.8 bar (depending of model)
Maximal temperature:	100°C (160°C on request)
Accuracy:	+/-5% Full Scale
Contact:	NO – Hysteresis 1.5 mm approximately
Connector:	DIN 43650 – IP65
Maximal pressure:	10 bar
Wetted parts:	Brass or stainless steel, Duran 50, gaskets
Construction	Housing in anodised aluminium Connections in stainless steel 316 Ti Float in brass or stainless steel 316 Ti Glass tube in Duran 50 Spring in stainless steel 316 Ti Gasket in NBR

Options (factory options)

Gasket:	FPM or EPDM
Contact:	Change over contact or ATEX certified contact

BAMO MESURES

22, Rue de la Voie des Bans - Z.I. de la Gare - 95100 ARGENTEUIL

Tél : (+33) 01 30 25 83 20 - Web : www.bamo.fr

Fax : (+33) 01 34 10 16 05 - E-mail : info@bamo.fr

Flow rate controller
and indicator
DUG

18-07-2007

725 I1 02 F

DEB

725-02/1

SWITCH – Characteristics

The switch is SPST type, NO / no flow. Reversing the contact, it is possible to have the NC action.
The adjustment is continuous, sliding the switch on a guide and fixed it up with a screw.
The output connection is realized through an IP 65 connector DIN 43650, PG 9.

Standard switch:

NO contact, switching power 230 V / 1 A / 50 VA

Change over contact:

On request, switching power 250 V / 1.5 A / 50 VA

ATEX certified contacts, on request

EEx m II T6: NO, 250 V / 2 A / 60 VA, cable output 1 m long
Change over, 250 V / 1 A / 60 VA

EEx ia II C T6: NO, 45 V / 1 A
Change over, 45 V / 1 A

CODE NUMBERS AND REFERENCES

Reference	Brass model	Stainless model	Range L/mn water	R on request	R Standard	S/P mm	D mm	B mm	T mm	L mm	Weight g
DUG-4	725 100	725 200	0,2 to 4	1/2"	1/4"	32	43	73	14	132	625
DUG-6	725 107	725 207	0,4 to 6	1/2"	1/4"	32	43	73	14	132	625
DUG-8	725 109	725 209	0,5 to 8	1/2"	1/4"	32	43	73	14	132	625
DUG-14	725 120	725 220	1 to 14	1/2"	1/4"	32	43	73	14	135	625
DUG-28	725 123	725 223	1 to 28		1/2"	32	43	73	15	135	650
DUG-45	725 126	725 226	2,5 to 45		3/4"	32	43	73	18	167	850
DUG-80	725 131	725 231	2 to 80	3/4"	1"	41	50	76	19	184	1 000
DUG-110	725 135	725 235	6 to 110		1"	41	50	76	19	184	1 000
DUG-150	725 137	725 237	15 to 150		1" 1/4	50	55	79	21	216	1 300
DUG-220	725 139	725 239	30 to 220		1" 1/4	55	60	81	21	210	1 700
DUG-250	725 141	725 241	35 to 250		1" 1/4	50	55	79	21	222	1 400

MOUNTING

DUG flow controllers are designed to work in any position.
The medium has to be free of any particles (a filter could be installed ahead). Do not install them in places where are magnetic fields. Use non-magnetic fittings for connection (plastic, brass or stainless). Any ferrous material part should be at a distance of 10 mm as a minimum. Switching power of contact: check your installation; if necessary use an amplifier relay (documentation 250). Set point adjustment: adjust the arrow in relation to the desired graduation.

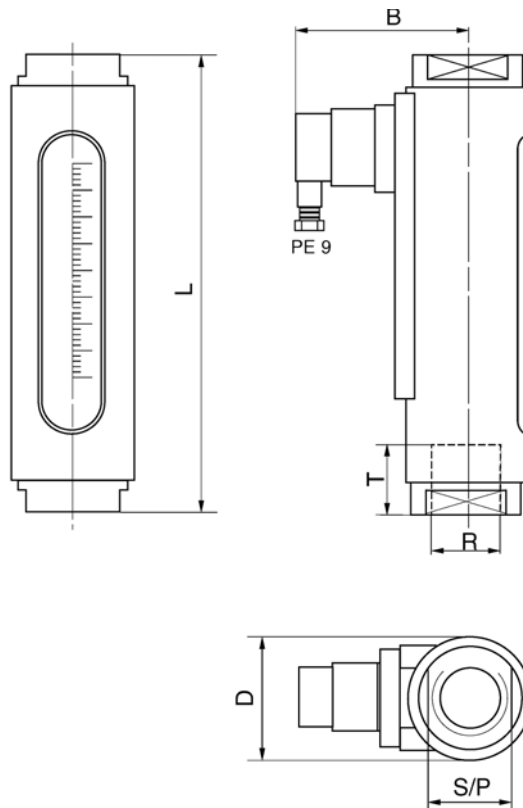

Flow rate controller
and indicator
DUG

DEB

725-02/2

BAMO MESURES

22, Rue de la Voie des Bans - Z.I. de la Gare - 95100 ARGENTEUIL
Tél : (+33) 01 30 25 83 20 - Web : www.bamo.fr
Fax : (+33) 01 34 10 16 05 - E-mail : info@bamo.fr

18-07-2007

725 I1 02 F