

# Flow controllers with viscosity compensation DKM - DKM/A



DKM

- Mounting: vertical or horizontal
- Reading on a sided graduated scale
- Not affected by pressure
- Viscosity compensation from 30 to 600 cSt
- Construction: brass or stainless steel
- Adjustable change over contact: N.O.
- Scales: 14 ranges from 0.1 up to 90 L/min
- Temperature: 0 to 120°C (160°C on request)
- Pressure up to 350 bar
- DKM/A: Reading + contact
- DKM: Blind, 1 Contact

## PRINCIPLE

The fluid moves over an orifice plate with a built-in magnet. A compensating spring allows the mounting in any position. The flow monitors DKM and DKM/A operate without incidence of pressure and viscosity variations.

On both models, a Reed contact is adjustable all along the scale. The contact is Normally Open (closing with overflow).

### DKM

It is a blind controller, standard supply with NO contact.

### DKM/A

In addition of a NO contact, an analogue display indicates the flow rate (even with quick variations of the fluid speed).

## TECHNICAL FEATURES

Maximal temperature:	0 ... 120 °C (160 °C on request)
Seals:	FPM
Viscosity:	30 to 600 cSt
Pressure drop:	0.02 to 0.4 bar (acc. to the scale)

### BRASS MODEL

Pressure limits:	300 bar in 1/2" – 250 bar in 1"
Construction:	Body and fittings: Brass Orifice plate: Brass Spring: Stainless steel 316 Ti Magnet: Ferrite

### STAINLESS STEEL MODEL

Pressure limits:	350 bar in 1/2" – 300 bar in 1"
Construction:	Body and fittings: Stainless steel 316 Ti Orifice plate: Stainless steel 316 Ti Spring: Stainless steel 316 Ti Magnet: Ferrite

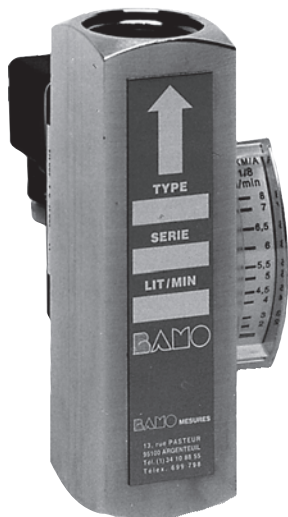

DKM/A

# BAMO MESURES

22, Rue de la Voie des Bans - Z.I. de la Gare - 95100 ARGENTEUIL

Tél : (+33) 01 30 25 83 20 - Web : [www.bamo.fr](http://www.bamo.fr)

Fax : (+33) 01 34 10 16 05 - E-mail : [info@bamo.fr](mailto:info@bamo.fr)

Flow controllers  
with viscosity compensation  
**DKM – DKM/A**

05-03-2015

723 I1 01 G

DEB

723-01/1

## SWITCHES

The adjustment is continuous, sliding the switch along its guide and fixed it up with a screw. The connector is type DIN 43650, IP 65; cable gland: PG 9.

As standard delivery, contact is NO; by rotating the contact 180° the status is NC.

### Contact NO

Switching power 230 V / 1 A / 50 VA

### Change over contact (option)

Switching power 250 V / 1.5 A / 50 VA

### Contact EX (option): Cable output 1 m long

EEx m II T6 – NO - maxi 250 V / 2 A / 60 VA

EEx ia IIC T6 – NO – maxi 45 V / 1 A

Change over version: maxi 250 V / 1 A / 30 VA

Change over version: 45 V / 1 A

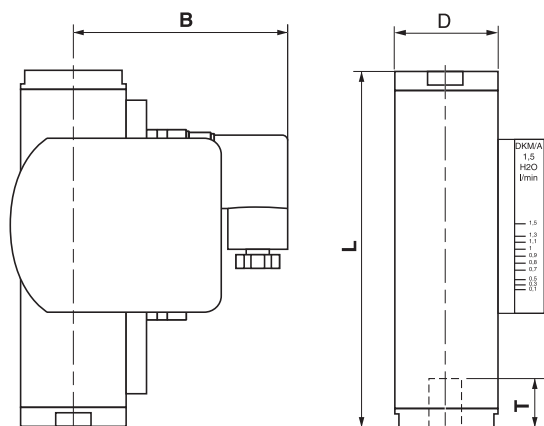

DKM/A

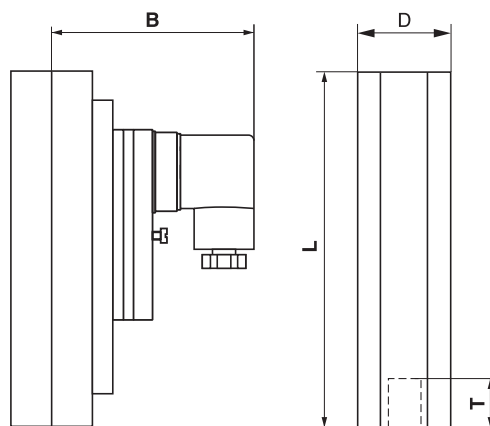
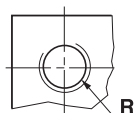

DKM

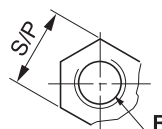

## CODE NUMBERS AND REFERENCES

Blind model	Brass type	Indicator model	Brass type	R"	Range L/mn	S/P mm	D mm	B mm	T mm	L mm	Weight g
DKM 2/2	723 115			½"	0.5 - 1.6	27	31	52	14	90	350
DKM 2/3	723 117			½"	0.8 - 3	27	31	52	14	90	350
DKM 2/7	723 119			½"	2 - 7	27	31	52	14	90	350
DKM 1/2	723 123	DKM/A 1/2	723 517	1"	0.5 - 1.5	40	40	76	17	130	1 200
DKM 1/4	723 127	DKM/A 1/4	723 519	1"	1 - 4	40	40	76	17	130	1 200
DKM 1/8	723 131	DKM/A 1/8	723 521	1"	2 - 8	40	40	76	17	130	1 200
DKM 1/10	723 134	DKM/A 1/10	723 522	1"	3 - 10	40	40	76	17	130	1 200
DKM 1/15	723 138	DKM/A 1/15	723 523	1"	5 - 15	40	40	76	17	130	1 200
DKM 1/24	723 142	DKM/A 1/24	723 525	1"	8 - 24	40	40	76	17	130	1 200
DKM 1/30	723 146	DKM/A 1/30	723 527	1"	10 - 30	40	40	76	17	130	1 200
DKM 1/45	723 150	DKM/A 1/45	723 529	1"	15 - 45	40	40	76	17	130	1 200
DKM 1/60	723 154	DKM/A 1/60	723 531	1"	20 - 60	40	40	76	17	130	1 200
DKM 1/90	723 158	DKM/A 1/90	723 533	1"	30 - 90	40	40	76	17	130	1 200
DKM 1/...	On request	DKM/A 1/...	On request	1"		40	40	76	17	130	1 350

**Stainless steel models:** For blind type code is 723 2.. // For display type code is 723 6..

**Graduated scale:** in L/min of Oil ISO VG 46 (124 cSt at 20°C) // Reading

: accuracy 5 % // Viscosity acceptance: 30 to 600 cSt

## MOUNTING

DKM and DKM/A flow controllers are designed to work on a vertical or horizontal position. The medium has to be free of particles (a filter could be installed ahead). Do not install the unit places where magnetic fields are. Use non-magnetic fittings for connection (plastic, brass or stainless steel). Ferrous material parts should be at a distance of 10 cm as a minimum. Switching power of contact: check your installation; if necessary use an amplifier relay (documentation 250-02). Set point adjustment: adjust the arrow in relation to the desired graduation.

# BAMO MESURES

22, Rue de la Voie des Bans - Z.I. de la Gare - 95100 ARGENTEUIL

Tel : (+33) 01 30 25 83 20 - Web : [www.bamo.fr](http://www.bamo.fr)

Fax : (+33) 01 34 10 16 05 - E-mail : [info@bamo.fr](mailto:info@bamo.fr)

Flow controllers  
with viscosity compensation  
**DKM – DKM/A**

05-03-2015

723 I1 01 G

**DEB**

**723-01/2**