

FLOW RATE INDICATOR AND CONTROLLER BMV



- For vertical mounting
- By side analogical indicator
- Free of pressure changes effect
- Brass or stainless steel construction
- 1 adjustable switch
- Range from 0.1 to 50 L/min in 7 scales
- 300 bar as a maximum (water at 20°C)
- 100°C as a maximum

DESCRIPTION

The BMV flow rate indicator is a variable area flow rate indicator. The instrument must be mounted on a vertical pipe with ascending flow. The acceptable fluid viscosity is close to water viscosity. These instruments may be available for airflow rate indication and control: on request.

The built in magnet of the diver drives the indicator. Coupling of both devices allow a continuous indication even with quick changes in the flow rate. The Reed contact, by side, is continuously adjustable. The switch is bi-stable and NO (*normally open with flow less*). It acts when the diver passes in front of it.

TECHNICAL FEATURES

Maximal pressure	Brass: 200 bar Stainless steel: 300 bar
Temperature:	0...100°C (160°C on request)
Scale:	In L/min of water at 20°C
Accuracy:	5 %
Bi-stable switch	NO (<i>flow less</i>), 250 V / 1.5 A / 50 VA Protection: IP 65 Connector: 43650 – cable inlet: PG 9
Brass model	wetted parts: brass and NBR seals
Stainless steel model	wetted parts: SS316 and FPM seals
Options (on request)	
Switch:	Change over contact ATEX certified switch for Ex area
Seals:	FPM, NBR, EPDM

Caution:

Verify the right correspondence of the switching power of the switch and your process device. A protective relay is described on data sheet 250-02.

BAMO MESURES

22, Rue de la Voie des Bans - Z.I. de la Gare - 95100 ARGENTEUIL

Tél : (+33) 01 30 25 83 20 - Web : www.bamo.fr

Fax : (+33) 01 34 10 16 05 - E-mail : info@bamo.fr

**FLOW RATE INDICATOR
AND CONTROLLER
BMV**

02-10-2009

721 I1 01 F

DEB

721-01/1

CODE NUMBERS AND REFERENCES

Type	Brass	Stainless steel	Range water 20°C, L/mn	R	S/P mm	D mm	D ₁ mm	B mm	T mm	L mm	Mass g
BMV-1 R	721 300	721 500	0,1 - 1,5	¼"	27	30	47	71	14	131	850
BMV-3 R	721 310	721 510	0,2 - 3,0	¼"	27	30	47	71	19	131	850
BMV-8 R	721 320	721 520	0,3 - 8,0	¼"	27	30	47	71	19	131	850
BMV-12 R	721 330	721 530	1 - 12	¼"	27	30	47	71	19	131	850
BMV-18 R	721 340	721 540	2 - 18	½"	27	30	47	71	17	148	1 010
BMV-35 R	721 345	721 545	3 - 35	¾"	34	40	57	76	18	152	1 500
BMV-50 R	721 350	721 550	4 - 50	1"	40	40	57	76	19	156	1 500

SWITCHES: Features

The switch fits on the dovetail (*rear face*) and is continuously adjustable; the position is secured with a blocking screw. The plastic DIN plug (*DIN 43650*) is IP65, with a cable inlet PG9.

Standard contact, NO (flow less)

Max. 230 V / 1 A / 50 VA

Change over contact (*Option*)

Max. 250 V / 1.5 A / 50 VA

ATEX certified contact

EEx m T6 - **NO** max. 250 V / 2 A / 60 VA – Change over contact max. 250 V / 1 A / 30 VA

Atex II 2G EEx m II T6 - **NO** max. 250 V / 2 A / 60 VA – Change over contact max. 45 V / 1 A

MOUNTING

- The flow indicators BMV are designed for a vertical mounting with an ascending flow.
- The fluid should be free of solid particles (*a filter could be used before the BMV*).
- All area must be free of magnetic fields.
- The fittings and or adaptors must be non-magnetic (*made of brass, stainless steel or plastic*).
- Any magnetic device should be at least above 10 cm from the BMV.

DIMENSIONS

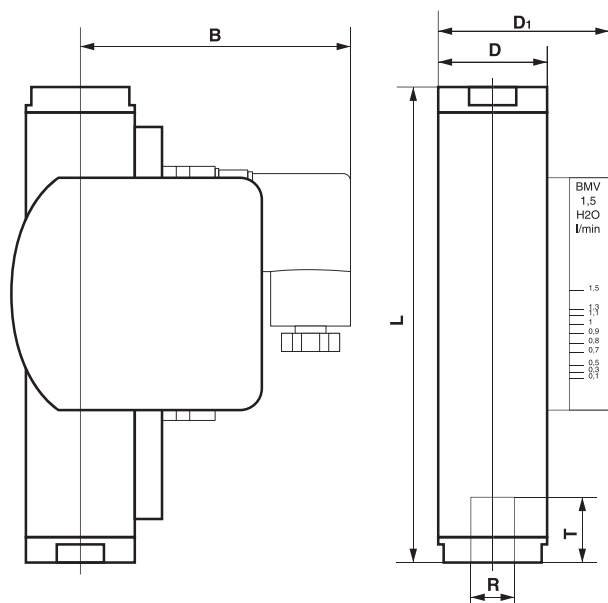

The detection loop is OPEN when the flow rate is lower than the trigger point.

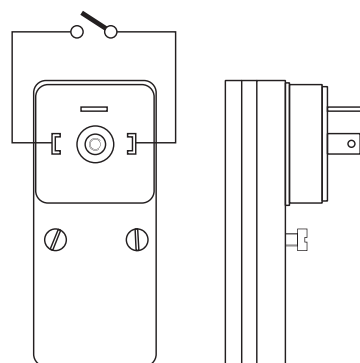

BAMO MESURES

22, Rue de la Voie des Bans - Z.I. de la Gare - 95100 ARGENTEUIL

Tél : (+33) 01 30 25 83 20 - Web : www.bamo.fr

Fax : (+33) 01 34 10 16 05 - E-mail : info@bamo.fr

**FLOW RATE INDICATOR
AND CONTROLLER
BMV**

02-10-2009

721 I1 01 F

DEB

721-01/2