

PADDLE FLOW SWITCH CDP



- Brass or stainless steel 316 Ti
- Nominal Diameter from 10 to 150 mm
- In-line mounting or insertion type

PRINCIPLE

The flowing liquid pushes the paddle. The stem head includes a magnet, and a spring keeps it in front of a Reed contact. When the pressure from liquid (high flow rate) is sufficient, the paddle compresses the spring, the magnet position changes and the Reed state changes. The CDP FLOW CONTROLLERS are in-line mounted up to ND 50 pipe with corresponding female threads. For greater diameters, it is an insertion type: CDP 52 with a BSP 1/2" male thread.

CONTACT

The Reed contact is NC either NO, 3 wires. It is recommended the use of a relay ES2001 to protect the Reed (please, see the documentation 250-01).

TECHNICAL FEATURES

Housing:	Stainless steel 316 Ti Brass
Ring:	FPM for stainless steel model NBR for brass model
Maximal temperature:	110°C
Ambient temperature:	70°C
Maximal pressure:	25 bar
Contact:	NO and NC according to index Switching power 230 V / 1.5 A / 80 W / maxi 90 VA
Cable:	3 x 1 mm ² wires Length 1.5 m PVC coated
Setting:	±15% of horizontal pipe value (report to the table)
Protection:	IP 65



MOUNTING

The setting values are for water at 20°C in a horizontal pipeline. The mounting can be vertical with upstream flow; the setting values will be increased. Maximal slope of downstream pipeline is 40%.

BAMO MESURES

22, Rue de la Voie des Bans - Z.I. de la Gare - 95100 ARGENTEUIL
Tél : (+33) 01 30 25 83 20 - Web : www.bamo.fr
Fax : (+33) 01 34 10 16 05 - E-mail : info@bamo.fr

**PADDLE FLOW SWITCH
CDP**

28-08-2007

710 I1 01 H

DEB

710-01/1

DIMENSIONS

CDP 10 to CDP 50

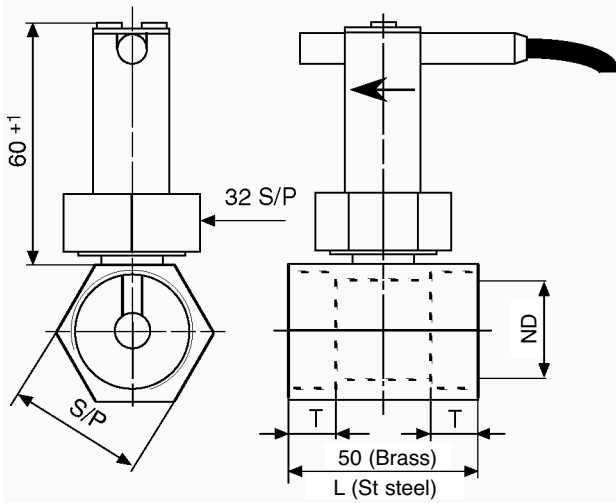

CDP 52

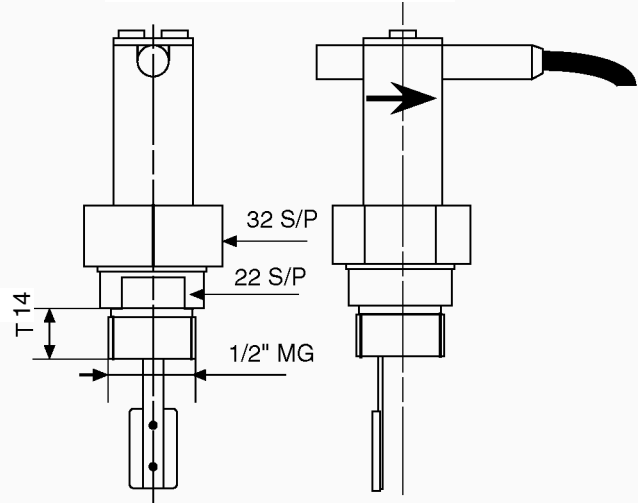

ND	10	15	20	25	32	40	50
L	50	50	50	74	88	95	114

WIRING

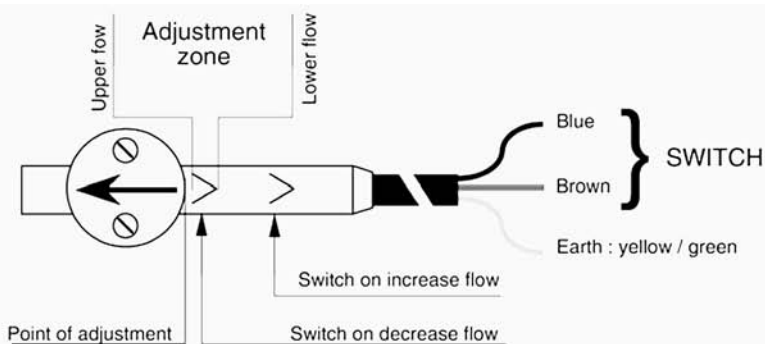

The regulation of 2 settings positions "Adjustment zone" is situated on 2 arrows area, but not between.

CODE NUMBERS AND REFERENCES

Type	ND Brass	R St Steel	CODE NUMBER		Flow-less switching between: L/min		Overflow switching between: L/min		Max Flow rate L/min	Dimensions	
			Brass	St Steel						T	S/P
CDP 10	10	3/8"	710 100	710 200	2,7	4,5	1,7	3,5	40	11	30
CDP 15	15	1/2"	710 115	710 215	4,5	6,6	3,0	5,5	45	11	30
CDP 20	20	3/4"	710 120	710 220	8,5	12,0	6,5	11,0	80	11	30
CDP 25	25	1"	710 125	710 225	13,0	20,0	11,0	19,0	130	15	37
CDP 32	32	1" 1/4	710 132	710 232	17,0	26,0	15,0	25,0	160	15	46
CDP 40	40	1" 1/2	710 140	710 240	28,0	45,0	27,0	43,0	300	15	52
CDP 50	50	2"	710 150	710 250	45,0	58,0	43,0	56,0	500	15	70
CDP 52	50	1/2"	710 152	710 252	44,0	65,0	40,0	60,0	500		

BAMO MESURES

22, Rue de la Voie des Bans - Z.I. de la Gare - 95100 ARGENTEUIL
 Tél : (+33) 01 30 25 83 20 - Web : www.bamo.fr
 Fax : (+33) 01 34 10 16 05 - E-mail : info@bamo.fr

PADDLE FLOW SWITCH CDP

28-08-2007

710 I1 01 H

DEB

710-01/2

710